



NIGHT HAWK

Hexacopter Drone with Wi-Fi Camera



User's Guide for Model DRW557 v1839-01

Warnings & Precautions

Important Safety Instructions

- Read and follow all instructions.
- Keep these instructions for future reference.
- Heed all Warnings.
- Intended for children ages 14 and higher. Adult supervision is required.
- Only use attachments/accessories specified by the manufacturer.
- Before flying, always check the body, rotors, and battery for any damage or obstructions.
- Battery should be free from cracks or swelling.
- Keep the rotors clear of any obstructions and body parts to avoid potential damage and injury.
- Manufacturer and dealer assume no liability for accidental damages from improper use or installation of parts, or from damage incurred from worn or broken parts.
- Pilots are responsible for their actions and any damage caused from improper use.
- Pilots should keep the craft in sight at all times during flight. If you lose sight of the craft at any time, power down and cease flight immediately.
- Only fly in large, open areas that are free from obstacles or potential hazards, such as trees, power lines, ceiling fans, and the like.
- Flying over bodies of water is not recommended.
- Flying at night is not recommended.
- Never try to retrieve the craft from areas you cannot safely reach, such as rooftops or trees.
- Never launch the craft from your hand.
- Never leave the craft unattended while it is powered on or while the battery is charging.

FCC Warnings

Warning: Changes or modifications to this unit not expressly approved by the party responsible for compliance could void the user's authority to operate the equipment.

NOTE: This equipment has been tested and found to comply with the limits for a Class B digital device, pursuant to Part 15 of the FCC Rules. These limits are designed to provide reasonable protection against harmful interference in a residential installation. This equipment generates, uses, and can radiate radio frequency energy and, if not installed and used in accordance with the instructions, may cause harmful interference to radio communications. However, there is no guarantee that interference will not occur in a particular installation. If this equipment does cause harmful interference to radio or television reception, which can be determined by turning the equipment off and on, the user is encouraged to try to correct the interference by one or more of the following measures:

- Reorient or relocate the receiving antenna.
- Increase the separation between the equipment and receiver.
- Connect the equipment into an outlet on a circuit different from that to which the receiver is connected.
- Consult the dealer or an experienced radio/TV technician for help.

Additional Warnings & Precautions

- **WARNING:** To reduce the risk of fire or electric shock, do not expose this apparatus to rain, moisture, dripping, or splashing.
- **CAUTION:** Use of controls or adjustments or performance of procedures other than those specified may result in personal injury.
- **WARNING:** Changes or modifications to this unit not expressly approved by the party responsible for compliance could void the user's authority to operate the equipment.
- **CAUTION:** Danger of explosion if battery is incorrectly replaced. Replace only with the same or equivalent type.
- Lithium batteries, like all rechargeable batteries, are recyclable and should be recycled or disposed of according to state and local guidelines. They should never be disposed of in normal household waste, and they should never be incinerated, as they might explode. Contact your local government for disposal or recycling practices in your area.
- **WARNING:** Shock hazard - Do Not Open.
- Battery shall not be exposed to excessive heat such as sunshine, fire, or the like.
- Keep new and used batteries away from children. If the battery compartment does not close securely, stop using the product and keep it away from children.
- If you think batteries might have been swallowed or placed inside any part of the body, seek immediate medical attention.
- Do not mix old and new batteries.
- Completely replace all old batteries with new ones.
- Do not mix alkaline, standard (carbon-zinc), or rechargeable (ni-cad, ni-mh, etc) batteries.
- Batteries should be recycled or disposed of as per state and local guidelines.
- **WARNING:** This product may contain chemicals known to the State of California to cause birth defects, or other reproductive harm (California Prop 65). Wash hands after handling.
- This product meets and complies with all Federal regulations.

Table of Contents

NIGHT Hawk Drone – 5

Features
Includes

Overview – 6

Craft Layout & Features

Assembly – 7

Landing Struts
Rotor Guards

Remote Control – 8

Functions
Battery Installation

Charging the Battery – 10

Flying – 11

Craft/Remote Link
When You're Finished Flying

Trim Adjustment – 13

Setting Trim & Countering Drift
Gyroscope Recalibration
Remote Trim Reset

Flying Tips & Features – 15

Tips for Safe Operation
Speed Setting
Headless Mode
Flips

Wi-Fi Flight – 17

Connect Wi-Fi
Settings Screen
Flight Screen
Intuitive Mode
Voice Control
Virtual Reality Mode

Smartphone Cradle – 21

Attachment
Removal

Parts & Repair – 22

Parts Replacement
Rotor Replacement

Troubleshooting – 23

Customer Support – 24

Contact Information
International Support
Warranty

NIGHT Hawk Drone

Features

- 360° flips & tricks
- 6-axis gyroscope
- Free app for Wi-Fi flight
- Voice activation
- Adjustable angle Wi-Fi camera
- 3 speeds
- Control distance: up to 300 feet
- LED navigation lights
- Glow in the dark rotors
- Operating time: 6-8 minutes
- Charge time: 120 minutes

Includes

- 2.4GHz remote control: requires 4 AAA batteries (not included)
- Rechargeable lithium polymer battery
- 6 replacement rotors
- Detachable smartphone cradle
- Screwdriver
- User's Guide



Overview

Craft Layout & Features

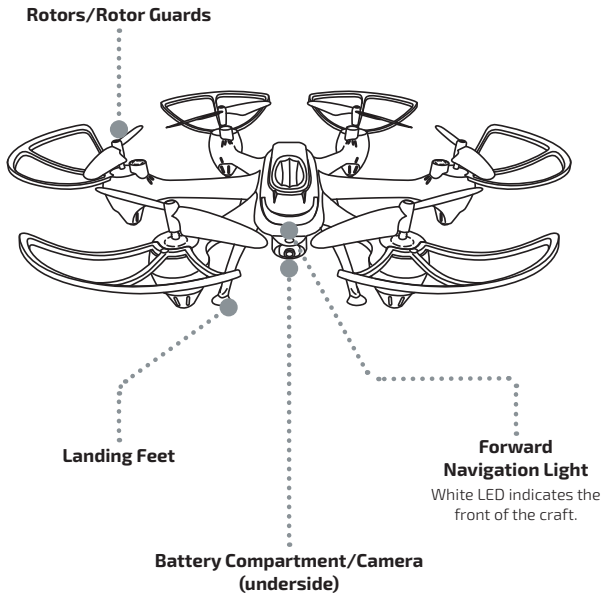

Assembly

Landing Struts



x4

Place each landing strut on the underside of the craft as shown, then tighten down with a screw and the included screwdriver.

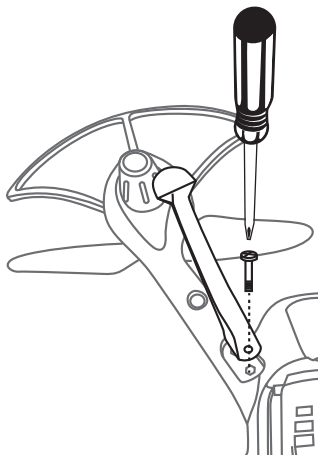

Rotor Guards



x4

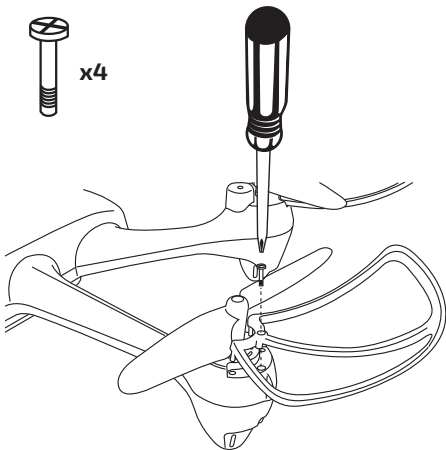

Attach each rotor guard as shown, then tighten down with a screw in the center location using the included screwdriver.

Remote Control

Functions

Headless Mode/ Reset

Press to turn Headless Mode ON or OFF.

Press to reset trim settings to default.

Power/Status Indicator

Flip

Press once, then move Right Control Stick in any direction to perform a flip.

Left Control Stick/Speed

Increase Throttle:
push forward

Decrease Throttle:
push backward

Yaw/Spin:
push left or right

Change Speed:
push down

Power Switch

Trim Adjustment

Right Control Stick

Pitch:
push forward/
backward

Roll/Bank:
push left/right

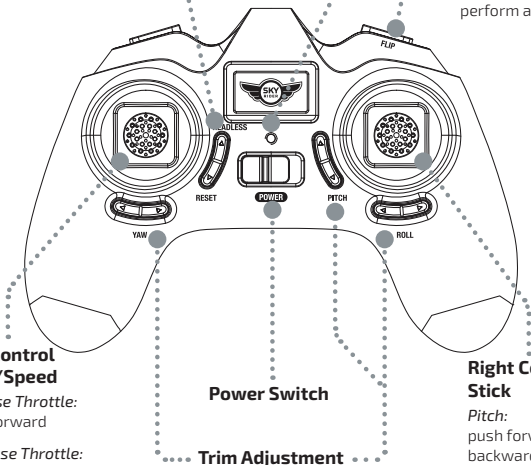

Battery Installation

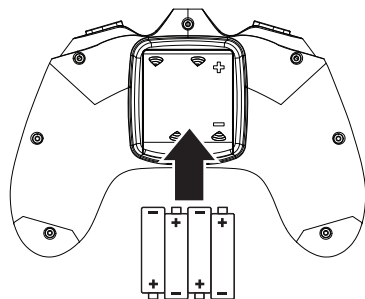
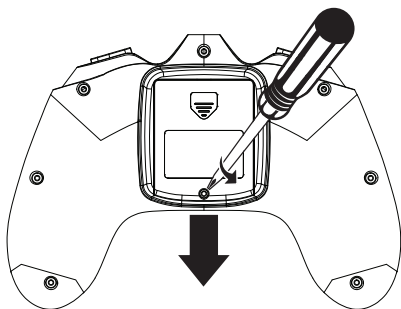

4x AAA batteries

Charging the Battery

Before charging, be sure the craft and remote control are powered OFF. Failure to do so may result in injury.

REMINDER: Do not charge batteries overnight. Do not leave the batteries unattended while charging.

Step 1

Open the battery compartment and disconnect the battery from the craft.

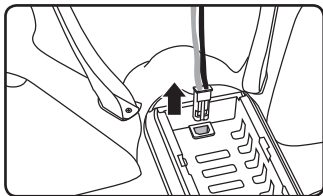

Step 2

Attach the plug on the battery to the plug on the USB charging cable (included).

Be sure to match the plugs correctly or damage may occur.

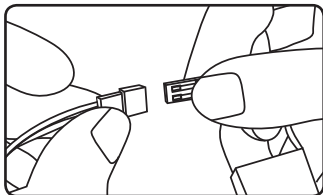

Step 3

Plug the USB charging cable in to the USB port of a powered ON computer or USB power adapter (not included).

While charging, the cable will display a red light.

When charging is complete, the light will turn OFF.

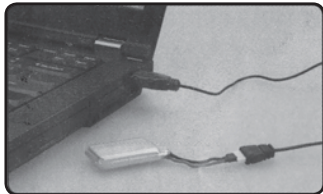

Flying

Craft/Remote Link

Before flying, the craft and the remote must be linked together and the gyroscopes on the craft must be allowed to calibrate.

Begin with the craft and remote powered OFF.

Step 1

Connect the battery and close the battery compartment, **then power ON the craft.** The LED navigation lights will blink as the craft searches for a signal from the remote.

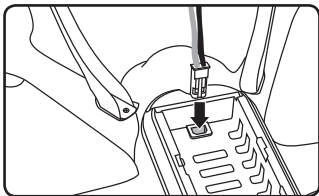

Step 2

Place the craft on a flat, level surface. **This is necessary for the craft's gyroscopes to properly align.**

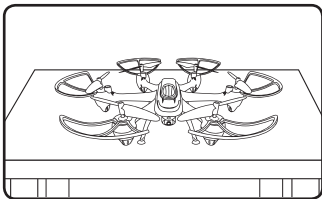

Step 3

Power ON the remote. The light on the remote will blink as it searches for the signal from the craft. An audible chime will sound when the remote and the craft have linked with each other.

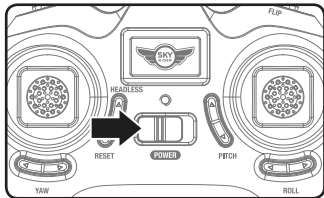

Flying

Step 4

Push the **Left Control Stick (throttle)** fully forward, wait for a chime to sound, then pull the stick fully rearward, and wait for a second chime. **When this last chime has sounded the craft is ready to fly.**

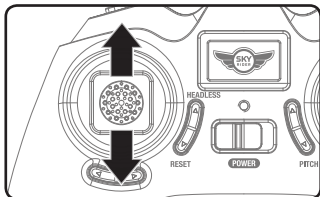

Step 5

Use the Left Control Stick to take off and control the throttle and Yaw (spin) movement of the craft.

Use the Right Control Stick to control the Pitch (forward/backward) and Roll (left/right) movement of the craft.

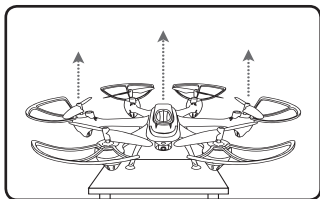

When You're Finished Flying

After landing, pull the Left Control Stick (throttle) fully rearward to power down and wait for the rotors to stop spinning. **Power OFF the remote BEFORE powering OFF the craft.** This will ensure that no signals are accidentally sent by the remote, reducing the chance of injury. After this is done, it is safe to pick up and power OFF the craft.

Trim Adjustment

Setting Trim & Countering Drift

Even after the craft is calibrated, it may show a tendency to drift while airborne. Adjusting the trim will help counter this effect and allow better control of the craft.

To avoid potential damage, adjust the trim while attempting a stable hover. Try to avoid making any exaggerated movements with the flight controls and adjust one trim setting at a time to avoid confusion.

Remember, the white LED navigation light indicates the front of the craft.

Note: Adjusting the trim will help with drift but it will not entirely eliminate it. Air currents and other factors may still cause slight drift while airborne. Adjusting the trim is meant to correct distinct and obvious drift that makes the craft difficult to control.

Craft **yaws/spins** to the left or right.

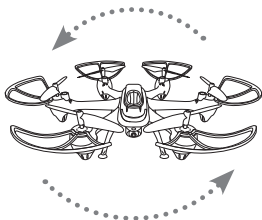

Adjust **Yaw Trim**.

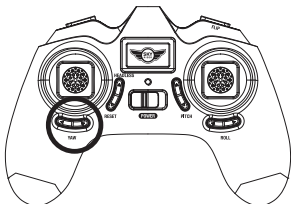

Craft **itches/angles** forward or backward.

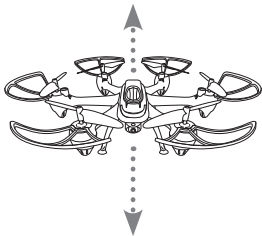

Adjust **Pitch Trim**.

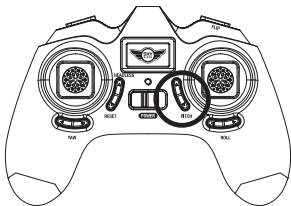

Trim Adjustment

Craft **banks/rolls** to the left or right.

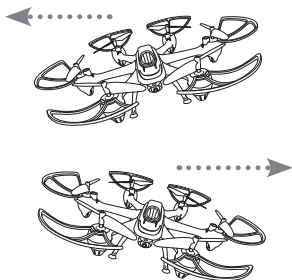

Adjust **Roll Trim**.

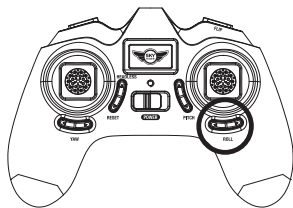

Gyroscope Recalibration

If the craft is experiencing difficulty flying or is behaving erratically, its gyroscopes may need to be recalibrated. Do not attempt to do this while flying, safely land the craft first and place it on a flat surface. The craft and the remote should already be linked together.

Pull down and to the right on both controls sticks for 2-3 seconds. When the LED lights have stopped blinking and turn solid the recalibration is complete and the craft is ready to fly.

Remote Trim Reset

If you are still having difficulty flying, it may help to reset the trim controls on the remote. Do not attempt to do this while flying, safely land the craft first.

Press the Reset button on the remote. The remote will chime once to indicate that the trim has been reset to default.

Flying Tips & Features

Tips for Safe Operation

- It is recommended to only fly in large, open spaces that are free of obstacles like power lines, trees, ceiling fans, etc.
- When flying indoors, avoid walls and ceilings, as the craft will be drawn towards them if closer than 2-3 feet.
- Stand behind the craft when first taking off, so that you and the craft are facing the same "forward" direction. This will help with orientation when the craft is airborne.
- Remember, the white LED light indicates the front of the craft.
- Novice pilots should move the controls slowly and deliberately to get used to the craft's flying characteristics. Try using one control at a time.
- Practice basic flight operations like take off, hovering, and landing.
- If you crash, power down the engines IMMEDIATELY to reduce the chance of damage or injury.
- If anything obstructs the propellers for any reason, throttle down IMMEDIATELY and safely clear the obstruction. Check for possible damage before flying again.

Speed Setting

Press down on the **Left Control Stick** once to set the craft's speed.

- **Low:** Provides smooth and predictable control of the craft. The remote will chime once to indicate the low speed setting.
- **Medium:** The craft will move and respond faster to all control inputs. The remote will chime twice to indicate the medium speed setting.
- **High:** Highest setting for maximum performance. The remote will chime three times to indicate the high speed setting.

Headless Mode

While Headless Mode is active the craft will fly in whatever direction the **Right Control Stick** is pushed, regardless of where the front of the craft is pointing. For example, if the front of the craft was pointed straight ahead but is now pointed right 90°, when you push forward on the stick the craft will fly forwards as if it was still pointed straight ahead. This can be useful if you become disoriented while flying and cannot visually determine which direction the craft is facing.

To activate Headless Mode, press the **Headless button** on the remote control. The LED lights will slowly flash while Headless Mode is ON. Press the button again to deactivate Headless Mode.

Flying Tips & Features

Flips

Before attempting a flip, be sure that there is ample clear space around the craft, ideally 9-10 ft. in all directions. It is not recommended to attempt to flip around or through any obstacles, as this may result in unintended damage.

Press the **Flip button** to activate Flip Mode, then move the Right Control Stick in any direction and the craft will perform a flip in the same direction. Press the **Flip button** again to deactivate without performing a flip.

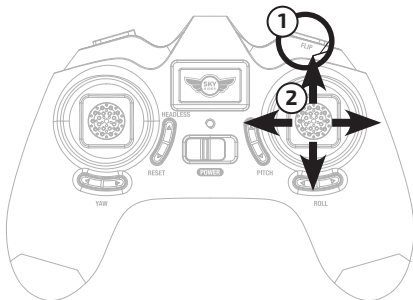
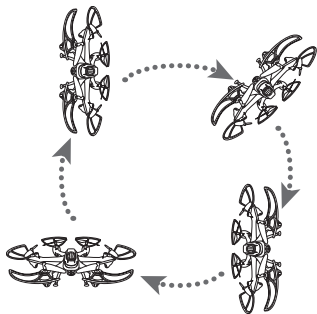

Wi-Fi Flight

The craft can be flown using a Wi-Fi linked smartphone and our free app. Scan the appropriate QR code to the right, or search for "**Sky Rider Vox**" in the Apple App Store or Google Play Store to download the app to your phone.

NOTE: Wi-Fi control may be interrupted by interference from other nearby 2.4G Wi-Fi equipment.



Apple



Android

Connect Wi-Fi

If you are going to fly using only your phone, do not power ON or connect the remote control. Before beginning, make sure your phone's Wi-Fi is enabled.

- Power ON the craft and place it on a flat level surface.
- Access the Wi-Fi settings menu on your phone, then search for and select **Sky Rider Vox** to connect to the craft.
- Once connected, open the app and click on the **Play** icon to begin flying.

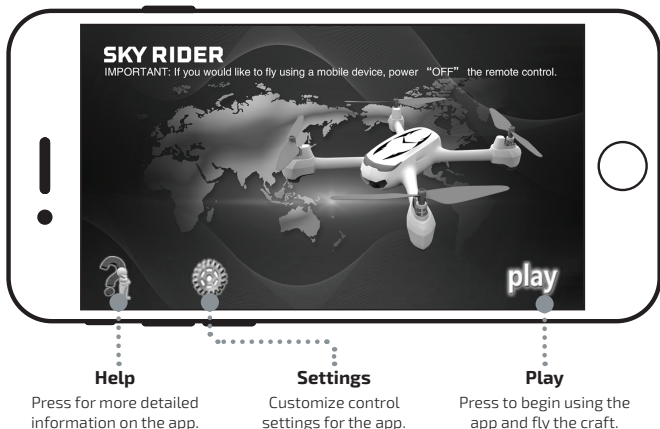

Wi-Fi Flight

Settings Screen

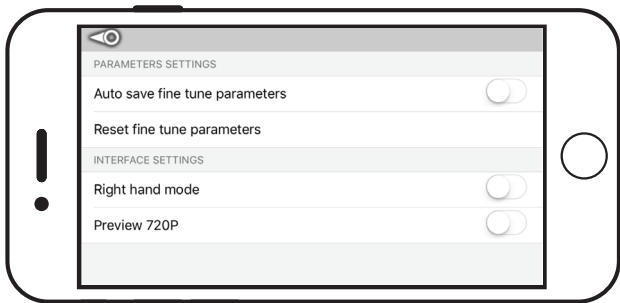

Auto Save Fine Tune Parameters

Trim settings adjusted in the app will be saved for future flights.

Reset Fine Tune Parameters

Reset trim settings to default.

Right Hand Mode

Reverses the locations of the Left and Right flight controls on the screen.

Preview 720p

Changes display resolution in the app from 480p to higher quality 720p. Display in 720p may be slower due to the greater amount of data being transmitted. Transmission is faster when using 480p. Transmission may be problematic in areas experiencing Wi-Fi interference.

Wi-Fi Flight

Flight Screen

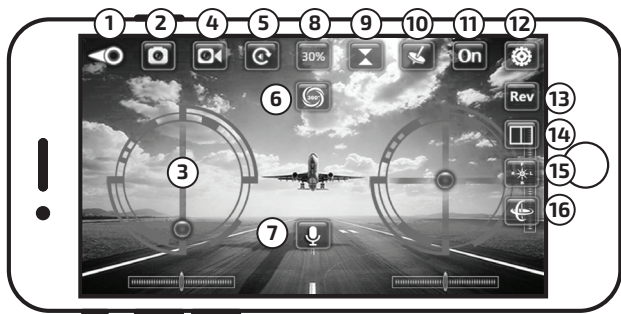

- | | | |
|-------------------------|-------------------------|---------------------------|
| 1. Start Screen | 7. Voice Control | 13. Flip Camera View |
| 2. Photo | 8. Speed Setting | 14. VR Mode |
| 3. Flight/Trim Controls | 9. Auto-Hover Mode | 15. Headless Mode |
| 4. Video | 10. Intuitive Mode | 16. Gyroscope Calibration |
| 5. Gallery | 11. Controls ON/OFF | |
| 6. Flip | 12. Additional Settings | |

Intuitive Mode

This mode uses the gyroscopes in your phone to control the craft. Tilt the phone forward, back, left and right to control the **pitch and roll** of the craft. **Throttle and yaw** are still manually controlled from the **Left Control Stick** on the phone's screen.

Voice Control

You can fly the craft by speaking specific commands into your phone. Press the Voice Control button to enable Voice Control Mode, then speak one of the commands from the list that appears on the flight screen.

Wi-Fi Flight

Virtual Reality Mode

VR Mode splits the phone's screen for use in a VR headset. **Press the VR button** on the screen to turn this feature ON or OFF. Use VR Mode to give a friend a fully immersive, point-of-view flying adventure.

NOTE:

- **We do not recommend flying the craft while wearing a headset.** The craft's camera has a limited forward view and the user's peripheral vision and situational awareness will be entirely obscured by the headset.
- On screen flight controls are locked out in VR Mode. You must have the regular remote connected in order to fly the craft (see next section).
- Images and video captured in VR Mode are not saved with the split screen view.
- **USERS ASSUME ALL RISK AND ARE RESPONSIBLE FOR ANY DAMAGE CAUSED BY IMPROPER USE.**

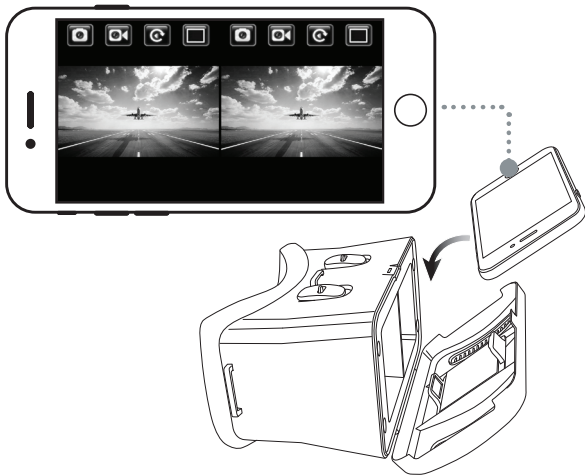

Smartphone Cradle

You can use your smartphone and the remote together by attaching the included smartphone cradle to the remote. This can be useful for photography and video, or for flying the craft just by watching the screen.

- First, connect the remote to the craft like normal. Connecting the remote first will override any control inputs from the app.
- Use your phone to connect to the craft via Wi-Fi and open the app. Use the remote to fly while the craft's camera displays on your phone's screen.
- When you're finished flying, power down the remote and craft like normal.

Attachment

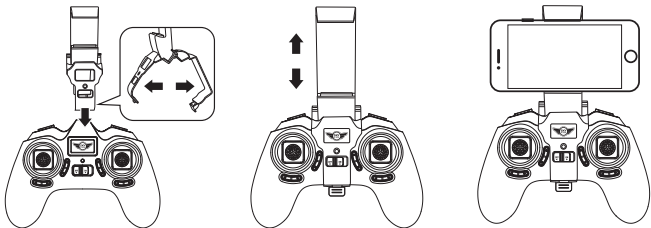

Removal

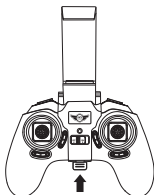

Push tab to release.

Parts & Repair

REMINDER: Pilots are responsible for any damage caused by improper use.

Parts Replacement

Standard parts such as extra batteries and remotes are available online for purchase when in stock. However, any non-standard parts such as cameras, screws, bodies, SD cards etc. can be ordered by placing an inquiry with our parts department at: partsinfo@dpiinc.com.

Rotor Replacement

The craft comes with replacement rotors if the originals are broken or badly damaged. Use the included screwdriver to loosen and tighten the screw connecting the rotor to the motor shaft. **It is extremely important to use the correct rotor (A or B) for replacement.** Using the incorrect rotor will make the craft impossible to control. The marking can be found on the rotor.

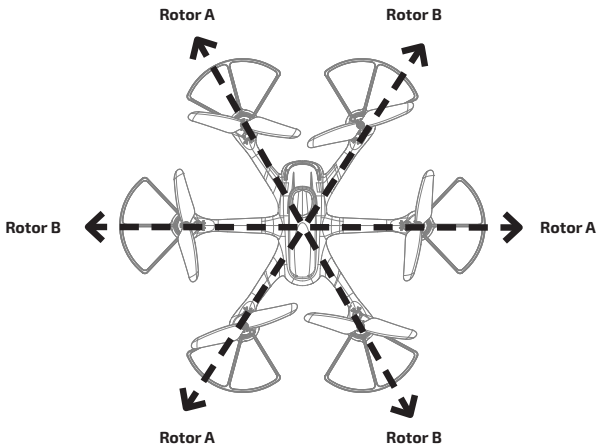

Troubleshooting

If you are experiencing problems using or flying the craft, consult this table.

PROBLEM	POSSIBLE CAUSES	SOLUTION
Craft does not respond to controls.	<ul style="list-style-type: none">• No power to remote or craft.• Poor contact between power plugs.• Craft is out of range.	<ul style="list-style-type: none">• Check remote batteries, replace if needed.• Check craft battery, be sure it is fully charged.• Be sure the power plugs are firmly connected.• Be sure the remote has an unobstructed line of sight to the craft.• Remain within the remote's 300 ft. range.
Craft is difficult to control or flies erratically.	<ul style="list-style-type: none">• Gyroscopes may be misaligned.	<ul style="list-style-type: none">• Power OFF remote and craft and reconnect (see pg. 11).
Craft drifts while in flight.	<ul style="list-style-type: none">• Trim not set or needs adjustment.	<ul style="list-style-type: none">• Adjust trim settings (see pg. 13).
Craft suffers from mechanical trouble.	<ul style="list-style-type: none">• Damage to body, rotors or other major components.	<ul style="list-style-type: none">• Repair or replace parts as needed.
LED lights ON but craft does not respond to controls.	<ul style="list-style-type: none">• Low battery power.	<ul style="list-style-type: none">• Recharge the battery.

Customer Support

Contact Information

Website: www.gpx.com

Email Support: prodinfo@dpiinc.com

Email Parts: partsinfo@dpiinc.com

Phone Support: **1-888-999-4215**

Warranty

See included 30 Day Warranty for warranty information. Warranty and the most up-to-date version of this User's Guide can also be found at: www.gpx.com

International Support

To download this User's Guide in English, Spanish, and French, or to get answers to frequently asked questions, visit the support section at: www.gpx.com

Para descargar este Manual del Usuario en inglés, español y francés, o para obtener respuestas a preguntas frecuentes, visite la sección de apoyo en: www.gpx.com

Pour télécharger ce guide de l'utilisateur en anglais, espagnol ou français, ou pour obtenir des réponses à des questions fréquemment posées, consultez la rubrique d'assistance sur: www.gpx.com



***Protect for Today
Sustain for Tomorrow***

Copyright © 2017 Digital Products International (DPI, Inc.) All other trademarks appearing herein are the property of their respective owners. Specifications are subject to change without notice.