

# Quickstart Guide

## Video/Audio Connectivity

Playing Video/Audio Through a Connected TV

### Component Video Output

1. Use the **Component Video Output** to send high quality video from the DVD player to a television.
2. Requires a component video cable (included).
3. Use the included component video cable to connect the **Component Video Output** to a component video input on a television.
4. Adjust the connected television's input setting to match the input used in the previous step.

### Troubleshooting

1. Confirm the video out connection type from the DVD player to the TV. There are two types of outputs on the DVD player. The first choice is to connect the Component Video (Red, Blue, Green) output to the Component video input on the TV. Component cables are included.
2. Select the INPUT type on the TV from the remote. Select the input that is the same as what was used in the initial hook up as outlined in point
3. If you still have an issue, some television models require that each Video INPUT is activated in the television's setup menu before any video signals can pass. Consult with your television manufacturer's user manual for further details.

## Component Video and RCA Stereo Audio

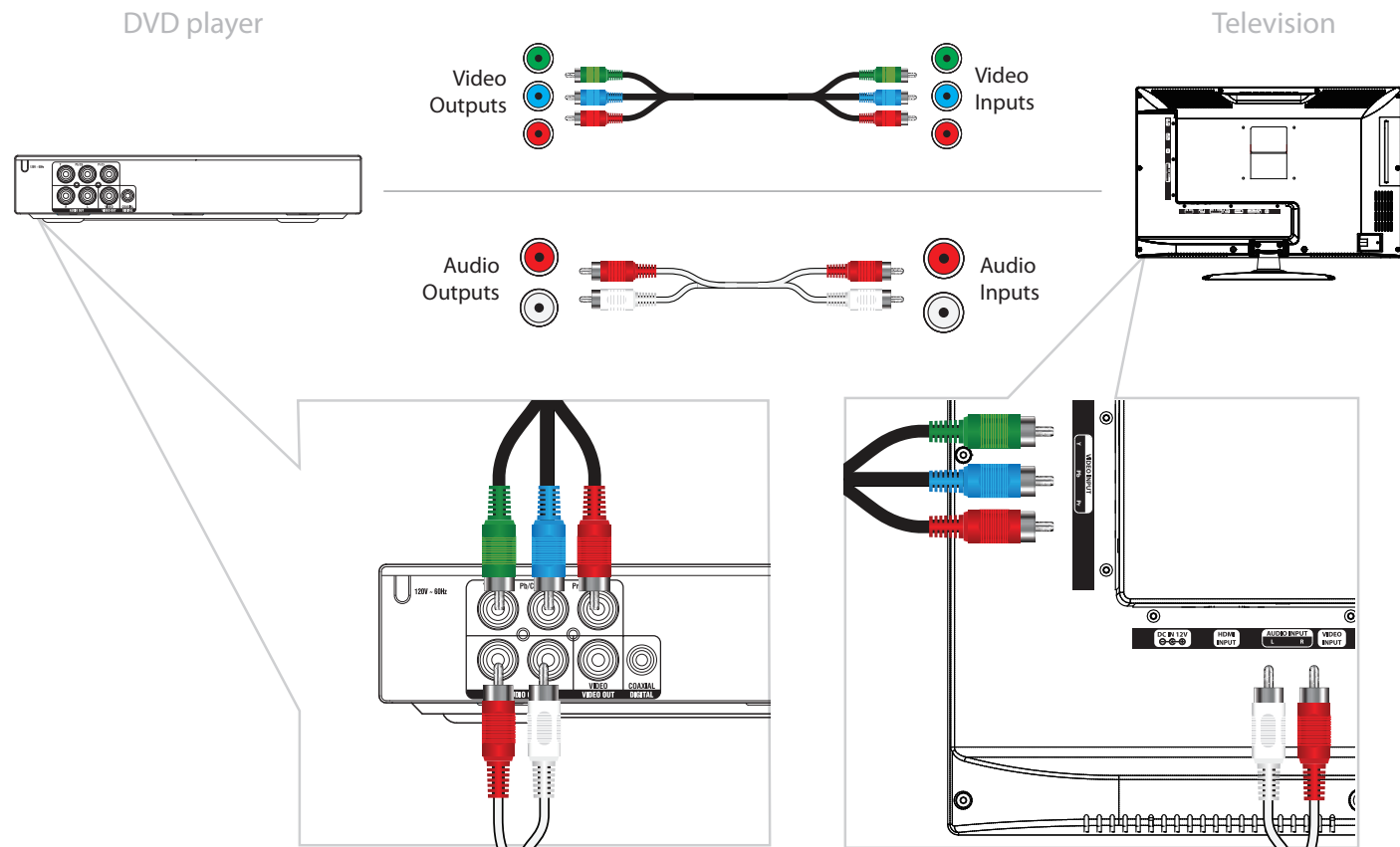

Note: Please make sure the power is off before making any connections.

# Quickstart Guide

## DVD and CD

### Loading a Disc

1. Press the **Open/Close** button to open the **Disc Drawer**.
2. Load a disc into the DVD player, label side facing up.
3. Press the **Open/Close** button to close the **Disc Drawer**.
4. After a disc is loaded, it will begin playing automatically.

### Playing a Loaded Disc

1. Follow the instructions for Loading a Disc.
2. If the disc does not begin playing automatically, press the **Play/Pause** button.

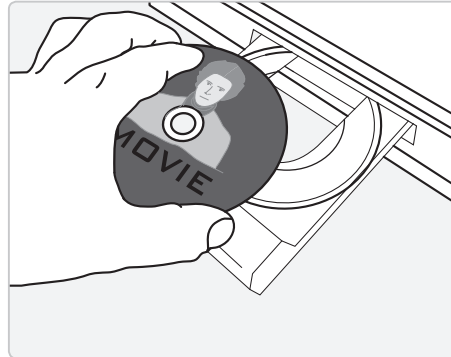

## Troubleshooting

### No Disc or Wrong Disc:

1. Confirm the disc is loaded into the tray label side up.
2. Confirm the disc is not scratched or damaged.
3. Confirm the disc is not a burned or copied disc as an incorrect format can affect playback.
4. Confirm the disc is a region 1 disc. Note: This player is programmed to only support region 1 disc.
5. Some Box rental discs have been used many times and become corrupted or damaged. This will cause the DVD player to state that the disc is unreadable. If that occurs, you should return the rental disc and have it replaced.

## Remote

### Troubleshooting

#### Remote Control Issues:

1. Confirm the batteries are inserted correctly. Check the + or – on the battery and confirm with the diagram in the IB or in the battery compartment of the remote to confirm they are inserted correctly.
2. If you are experiencing slow or no response from the remote, replace the batteries with new “AAA” batteries.
3. Check remote functionality by observing the remote IR light through the lens of a digital camera, in low lighting, while a button on the remote is pressed. Note: You should see a blue light flashing in the remote IR LED.